

STU. + 2.10
BRÜ. + 0.78

STU. + 2.10
BRÜ. + 0.78

STU. + 2.10
BRÜ. + 0.78

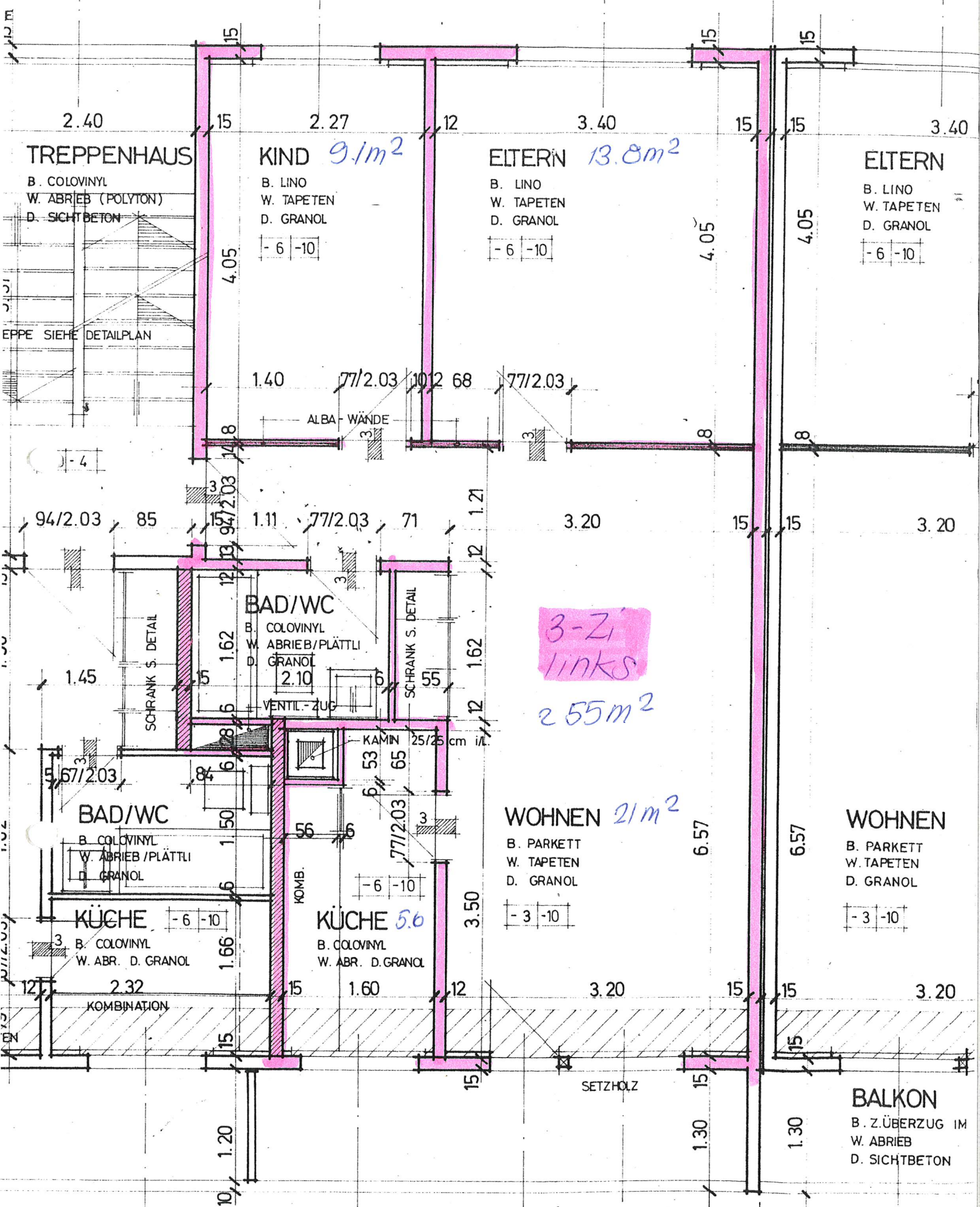

STU. + 2.10
BRÜ. + 1.18

STU. + 2.10
BRÜ. + 1.18

STU. + 2.10
SCHW. + 0.02
BRÜ. + 0.78

STU. + 2.10
BR. + 0.87

(A)