

181

14

23a

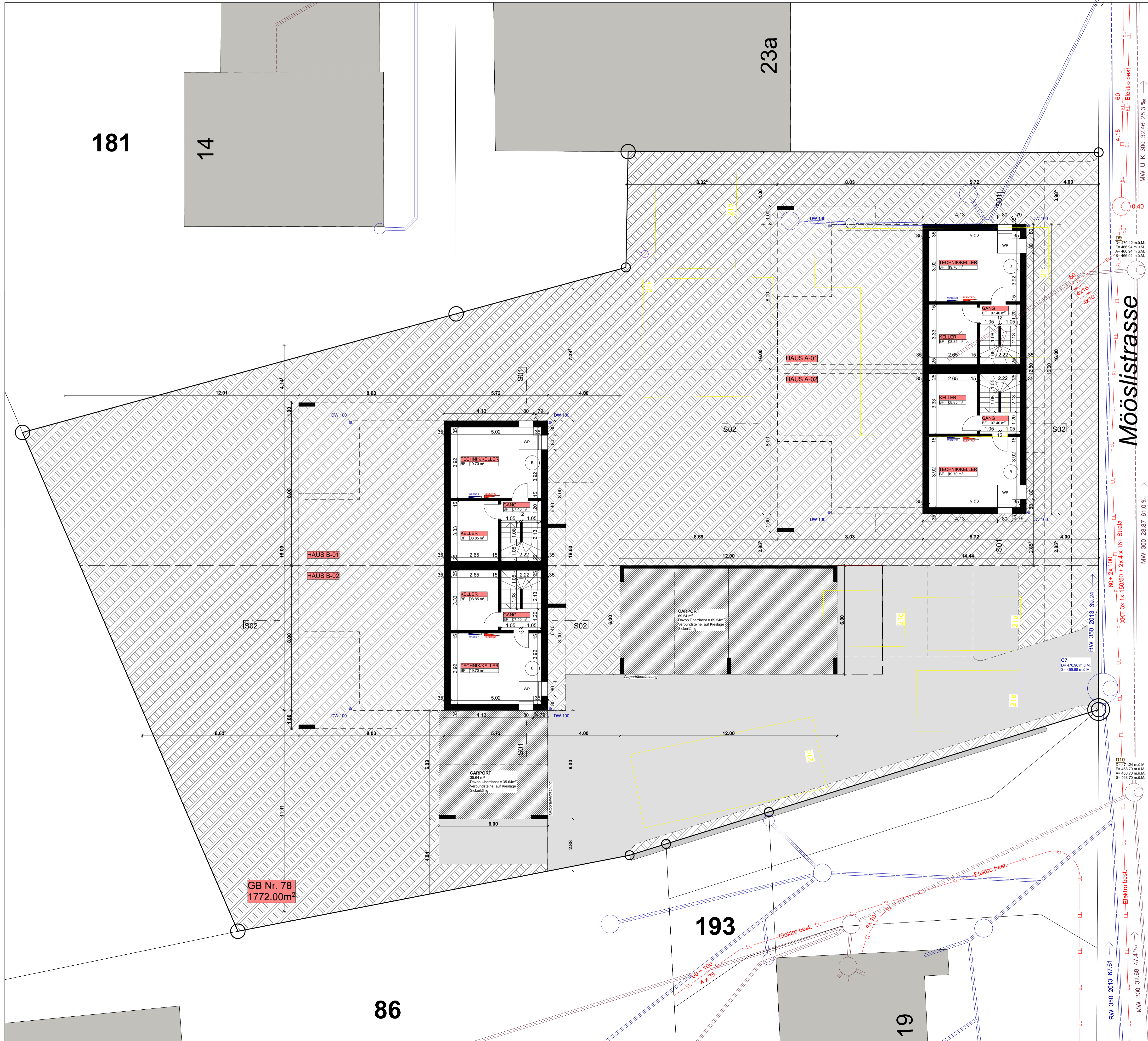

GB Nr. 78  
1772.00m²

86

193

19

Möslistrasse

D10  
D= 470.12 m o.M.  
E= 468.94 m o.M.  
A= 468.94 m o.M.  
S= 468.94 m o.M.

D10  
D= 470.90 m o.M.  
E= 468.70 m o.M.  
A= 468.70 m o.M.  
S= 468.70 m o.M.

D10  
D= 470.12 m o.M.  
E= 468.94 m o.M.  
A= 468.94 m o.M.  
S= 468.94 m o.M.

MW U. K. 300 32.46 25.3 %

MW 300 25.87 61.0 %

RW 350 2013 39.24

RW 300 25.87 61.0 %

RW 350 2013 39.24

RW 300 25.87 61.0 %

RW 350 2013 39.24

RW 300 25.87 61.0 %

RW 350 2013 39.24

RW 300 25.87 61.0 %

RW 350 2013 39.24

RW 300 25.87 61.0 %

RW 350 2013 39.24

RW 300 25.87 61.0 %

RW 350 2013 39.24

RW 300 25.87 61.0 %

RW 350 2013 39.24

RW 300 25.87 61.0 %

RW 350 2013 39.24

RW 300 25.87 61.0 %

RW 350 2013 39.24

RW 300 25.87 61.0 %

RW 350 2013 39.24

RW 300 25.87 61.0 %

RW 350 2013 39.24

181

14

23a

Möslistrasse



GB Nr. 78  
1772.00m²

193

86

19

181

14

23a

Möslistrasse



GB Nr. 78  
1772.00m<sup>2</sup>

193

86

19



181

14

23a

Mösslstrasse

GB Nr. 78  
1772.00m<sup>2</sup>

193

86

19