

*T. Wagner  
Lea Wagner*

ST. +4.02  
BR. +3.42

ST. +4.04  
SW. +2.03

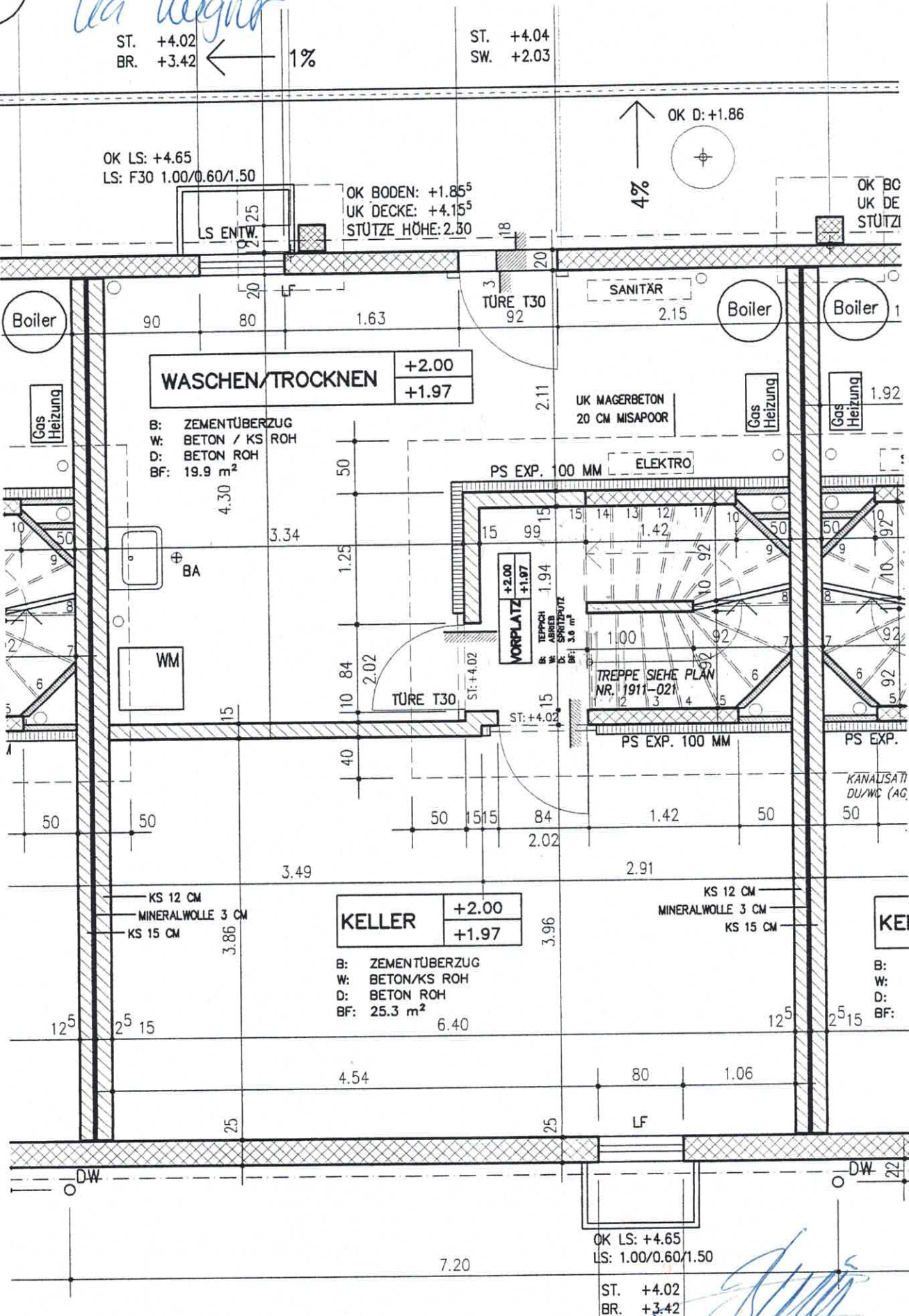

**WASCHEN/TROCKNEN**  
+2.00  
+1.97

B: ZEMENTÜBERZUG  
W: BETON / KS ROH  
D: BETON ROH  
BF: 19.9 m<sup>2</sup>

**KELLER**  
+2.00  
+1.97

B: ZEMENTÜBERZUG  
W: BETON/KS ROH  
D: BETON ROH  
BF: 25.3 m<sup>2</sup>

OK LS: +4.65  
LS: 1.00/0.60/1.50

ST. +4.02  
BR. +3.42



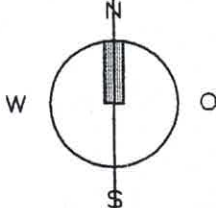

*J. Wagner  
K. Wagner*

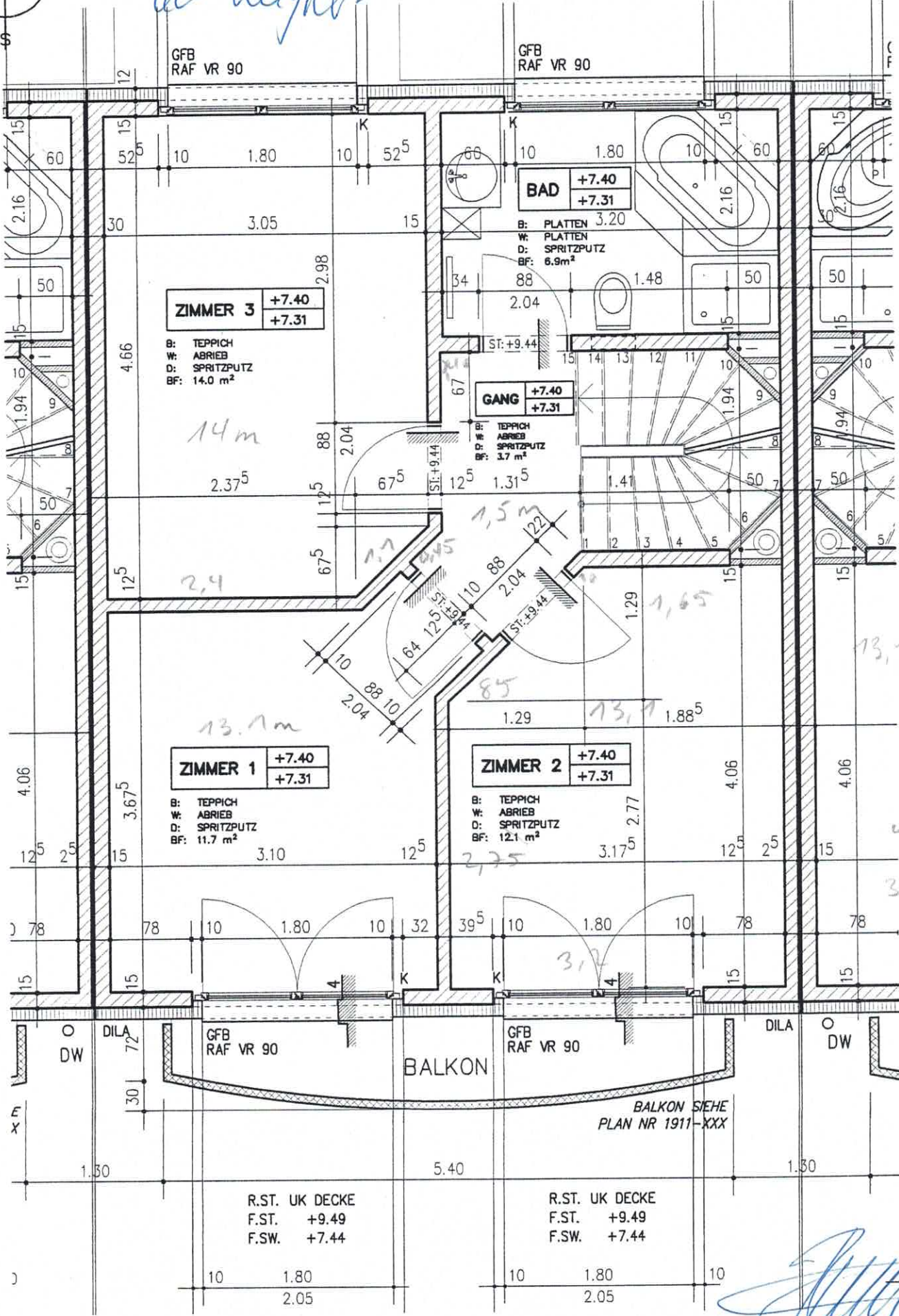

*[Signature]*  
 Ammann Globalbau AG

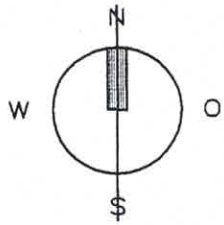

*J. Wagner  
lex Wagner*

