

# Bau 70 1.OG

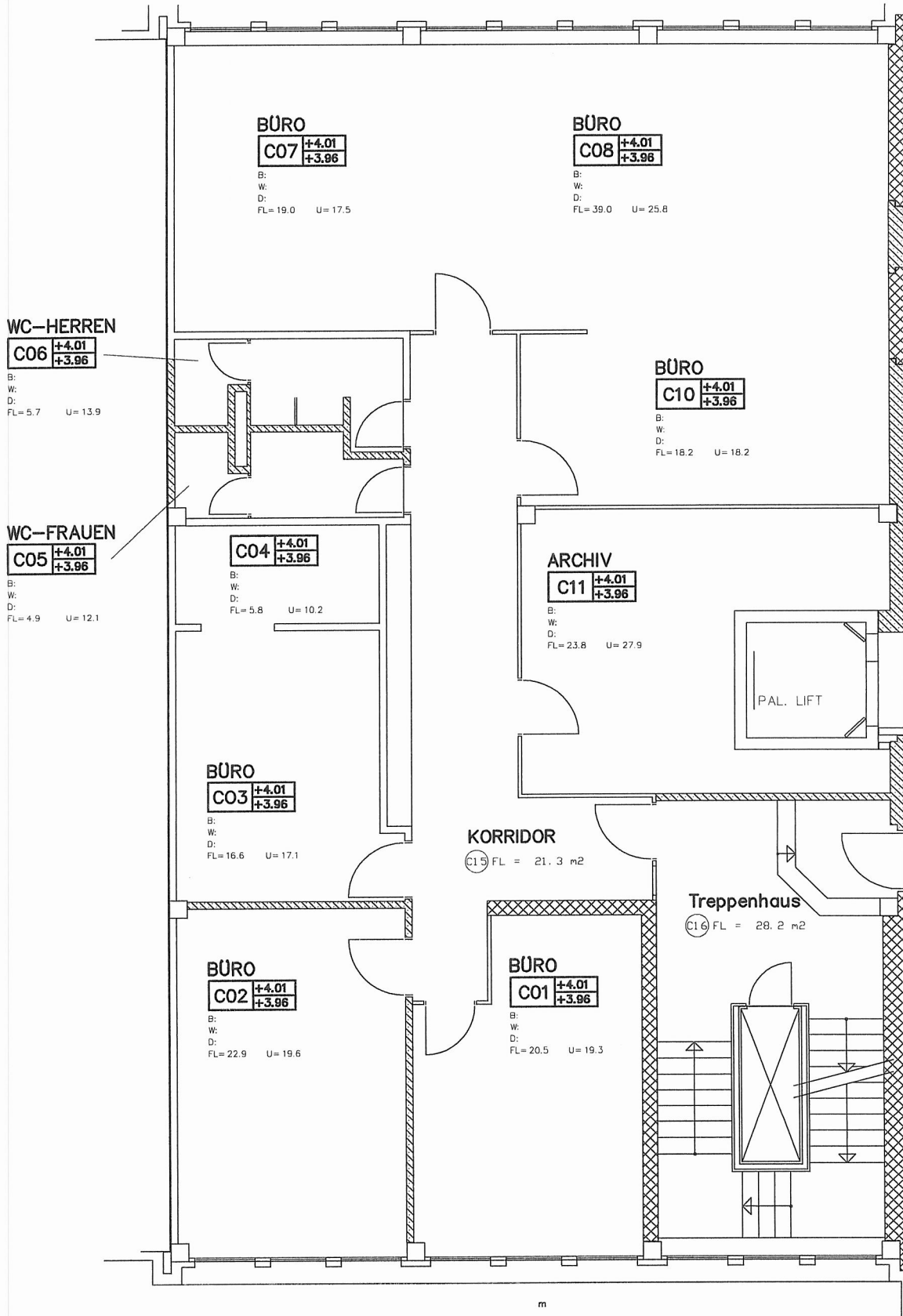

**BÜRO**  
**C07**

+4.01
+3.96

  
 B:  
 W:  
 D:  
 FL= 19.0 U= 17.5

**BÜRO**  
**C08**

+4.01
+3.96

  
 B:  
 W:  
 D:  
 FL= 39.0 U= 25.8

**WC-HERREN**  
**C06**

+4.01
+3.96

  
 B:  
 W:  
 D:  
 FL= 5.7 U= 13.9

**BÜRO**  
**C10**

+4.01
+3.96

  
 B:  
 W:  
 D:  
 FL= 18.2 U= 18.2

**WC-FRAUEN**  
**C05**

+4.01
+3.96

  
 B:  
 W:  
 D:  
 FL= 4.9 U= 12.1

**BÜRO**  
**C04**

+4.01
+3.96

  
 B:  
 W:  
 D:  
 FL= 5.8 U= 10.2

**ARCHIV**  
**C11**

+4.01
+3.96

  
 B:  
 W:  
 D:  
 FL= 23.8 U= 27.9

**BÜRO**  
**C03**

+4.01
+3.96

  
 B:  
 W:  
 D:  
 FL= 16.6 U= 17.1

**KORRIDOR**  
 C15 FL = 21.3 m<sup>2</sup>

**Treppenhaus**  
 C16 FL = 28.2 m<sup>2</sup>

**BÜRO**  
**C02**

+4.01
+3.96

  
 B:  
 W:  
 D:  
 FL= 22.9 U= 19.6

**BÜRO**  
**C01**

+4.01
+3.96

  
 B:  
 W:  
 D:  
 FL= 20.5 U= 19.3

